

1016-S Single Bowl Sink

I.D.: 15 3/4" x 10" (400 mm x 254 mm)
Depth: 4 1/8"* (105 mm)
*Depth does not include counter top thickness



The Gemstone 1016-S Single Bowl Sink provides a seamless kitchen utility/ laboratory sink in any solid surface sheet material, acrylic, polyester or blended. This sink fits well in a tight places or in any

situation where a small, rectangular sink is required, including residential, clinical, or other commercial uses. This sink can be installed in either direction.

Gemstone Sinks are compatible and warranted when used with all major solid surface sheet brands with the same sheet warranties.

 Gemstone supports conservation and green building practices. Gemstone Packages all products in 100% recyclable packaging using boxes made primarily of recycled paper.

 Gemstone sinks are proudly made in the USA and certified by:
Home Innovation Lab (NAHB): HUD UM Bulletin No. 73a & (B45.5/IAPMO Z124 Z124.6)
UL in the US and Canada: HUD UM Bulletin No. 73a & (B45.5/IAPMO Z124 Z124.6)



For router bit recommendations visit:
www.Gemstoness.com/Tech

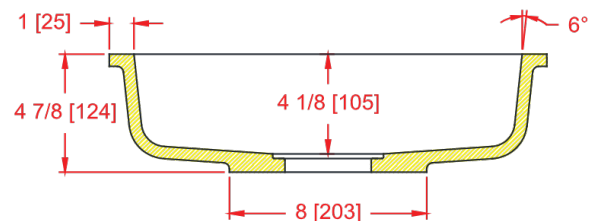
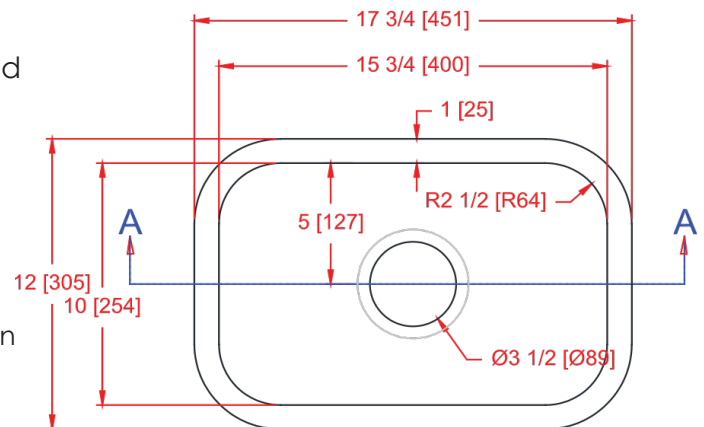

Section A-A