

### 1514-V ADA Lavatory Bowl

(No Overflow Model)

I.D.: 15 1/4" x 13 7/8" (387 mm x 352 mm)	 <b>ADA</b> Compliant
Depth: 5 1/4"* (133 mm)	
*Depth does not include counter top thickness	



The Gemstone 1514-V ADA lavatory shape allows the vanity bowl to be placed as close to the front of the top as needed without compromising ADA conformance. The offset drain prevents splash out when using commercial drain

grid strainers. This bowl is ideal for hospital and clinical applications where infection control and design are priorities, as well as, restaurants and other public spaces providing excellent performance. This bowl has a side overflow option. Please see the specification for the 1514-VO.

Gemstone Sinks are compatible and warranted when used with all major solid surface sheet brands (acrylic and polyester) with the same sheet warranties.

 Gemstone supports conservation and green building practices. Gemstone Packages all products in 100% recyclable packaging using boxes made primarily of recycled paper.

 Gemstone sinks are proudly made in the USA and certified by:

**Home Innovation Lab** (NAHB): HUD UM Bulletin No. 73a & (B45.5/IAPMO Z124 Z124.6)

**UL** in the US and Canada: HUD UM Bulletin No. 73a & (B45.5/IAPMO Z124 Z124.6)



For router bit recommendations visit:  
[www.Gemstoness.com/Tech](http://www.Gemstoness.com/Tech)

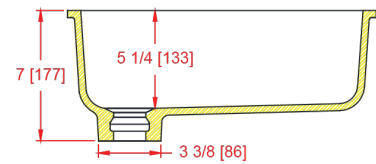
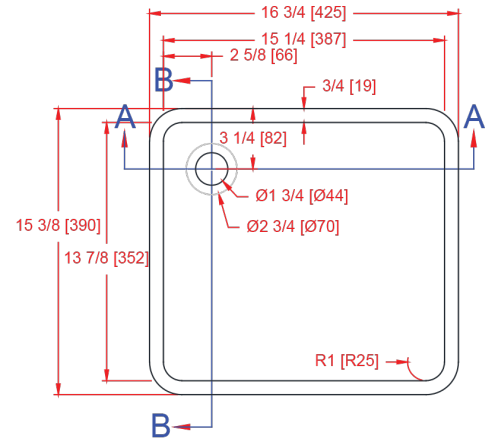

Section A-A

